

INTERNATIONAL ROOFING EXPO

February 22 - 24, 2012

Orange County Convention Center - South Hall A

Orlando, Florida USA

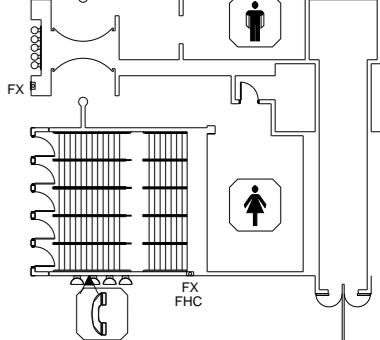

EXHIBITOR SERVICE DESK

Security Office
IRE Sales Info Center #370

DEMO STORAGE
Salz Tool 366
EcoStar LLC 362

PRODUCT SHOWCASE #367

LIVE DEMO AREA #253

Arrow Magn 248
Premier Rail Systems 247
Textured 348
Reserved 346
SnoBI 245
Conkili 344
WEG ENER 243
Erbate 342
Chid 342

Classi c 232
Milsp ec 230

S-5!

Roof AquaGuard

Gulf Coast Supply & Supply

Metal Construction Association

Drexel 200

Design 363
Reserved 361
ConnectPol 460
Polyte ch 458
Nutech 456
LifePi ne / 355
Coati ngsPr 454
DeWitt Produ 353
Adva need 452

CNA
20' 347
20' NRCA 443
20' Ameri safe, 549
20' Braadury Roofing, The 646
20' NEOG ARD 545
20' Perma -Boot 543
20' NUHE AT 541
20' Equip et 539
20' MFM Building 638

Equipet Product Clinic #531

Alpha Pro Tech

Graco Inc

Graco Inc

Graco Inc

Graco Inc

678
676

679 778
677 776

779 878
777 876

ExpDateE 20' OC 978
877 Picto 976

979 1078
977 Solleg 977
May Adver 1076

1079 1178
1077 Appli Cad 1077
RMI 1176

1179 1278
1177 Internat 1177
Henn es- 1276

EMR #2

EMR #5

EMR #3

EMR #6

EMR #7

573 672
571 Reser ved 571
Reser ved 670

EMR #4

Bristol ite 773
Elk River Inc 769
Atlas Roofing Corporation 868

McNic hols 873
Robet ex, 972
Abco Work 970
BAK Therm 968
Quality Crafty 869

Miller Fall Protection/ 971
Lifitin g 1072
Conv enien 1070
South easter 969
4 Cs Spray 1068

Enduro 1073
Natura l Light 1172
MAXI FLO 1071
Nardin I.S.p.A 1170
Speci ality 1069
Unity Surfac 1168

Aztec Wash 1173
Int Co. For Insulation 1169
Firestone Specialty Products 1268

EMR #1

20' 3C Network 1369

Senoflex, 20' inc. 1471
FanelClaw 1570
GoofT ech Rackl 1469
KB 1568
1568

Ancho r 1573
Nova gard 1670
Ceram ica 1571
Ecolo gy 1670
Flash Co 1569
Pallisa des 1668
Boral Roofin 1567
Atlant ic 1666

CONCESSIONS

20' Fortuna Logistics/Ma xCon 563

20' Safety Anchor Fall Equipment Corporation 663

NASCAR Experience #763

20' Acculynx.com 861

Roofing Contractor 963
Sasho 1062
Safet y 1060
HaliW ATCH 961

E-Z Gutter 1065
On Top 1164
Lexco f, a 1162
National Nail Corp. 1061
Inland Coatings 20' 1158
Bitum ar 1059

Acme Cone 1165
SESC O 1264
RCI, Inc. 1163
BUZO N 1161
United 20' Union of 1260

Reeve s 1265
Flame Engin 1263
Unite d 1261
SAFE PRO 1360

Tropical Roofing Products 1361

Sun-Tek 1465
Advan ced 1564
CNBM Intern 1463
Temp e- 1562
Burkel ine 1560
RoofS lope 1558
1459

Roxul, Inc. 1559
Ski Slope 1660
Crysa m 1658

Metal Plus 1665
Aspha lit 1764
Paint Valley 1663
1762
Neptu n 1661
KBI Flexi- 1760
O'Hag in's, 1659
SunMi zer 1758
Santafe Tile 1657
Cool Roof 1756

Sustainability Pavilion #1753

1865
Reser ved 1863

Plaste co Inc. 559
Resolite 658
Solar Energ 557
Refle ctive 656
Roofs 555
Capit al Supply (CBI) 652
DCI Produ 553

Opus Roof Blanket 657
ALT Global 758
OFIC North America 754
Coll Maste ri 754
Triple Crown 752
Colbo nd. 653

Lucas Lightings 757
WDT - Weath 856
Infra- Red 854
Ever green 852
RHH Foam 753

20' EagleView Technologies 853

Steels cape 957
Guilbert 1056
Cedar Shake 955
GEM LINK 953

20' SIPLAST 1053

20' FiberFite Roofing Systems by Seaman Corporation 1252

20' Georgia-Pacific Gypsum 1253

20' Air Vent Inc. 1353

20' Uniflex Applied Roofing Systems 1453

20' All Seasons Equipment 1553

ACH Foam 1655
Amere sco 1754
EDCO Produ 1653
Phase Chang 1752

1861
Schletter Inc. 1857

1853
Orion Energy 20'

20' Cargotec USA Inc., Hiab

20' FailTech 341
20' NRCA ROOSPAC 440
20' Hetrick Cyr 339
20' The Roofi 438
20' FRSA 337
20' Gaco Waste 436
20' PRI Const 335
20' Everhard 434
20' Thund erbird 333
20' Arkem a, Inc. 331
20' Malmat Coatings 430

20' Equip et 539
20' MFM Building 638

20' Rooflogi c 731

20' OMG Product Clinic #931

20' Carlisle SynTec Systems 1031

20' Johns Manville 1230

20' Sharkskin 1235

20' Owens Corning 1331

20' Tarco 1437

20' InterWrap, Inc. 1639

20' USG SEUROCK Roof Boards 1631

20' Interwrap, Inc. 1731

20' Global 1838
20' Mome ntum 1836
20' North Count 1735
20' Lyon Metal 1834
20' Classi c 1832
20' Heate c, Inc. 1830

20' Gerard/Allm et Roofing Products 231

20' Everhard 434

20' Equip et 539

20' Rooflogi c 731

20' OMG Product Clinic #931

20' Carlisle SynTec Systems 1031

20' Johns Manville 1230

20' Sharkskin 1235

20' Owens Corning 1331

20' Tarco 1437

20' InterWrap, Inc. 1639

20' USG SEUROCK Roof Boards 1631

20' Interwrap, Inc. 1731

20' Global 1838
20' Mome ntum 1836
20' North Count 1735
20' Lyon Metal 1834
20' Classi c 1832
20' Heate c, Inc. 1830

20' Kingspan Insulated Panels 325

20' Berger Building 421
20' PPG Indust 419
20' Metal Sales 417
20' World Gutter Systems, Inc. 411
20' Berridge Manufacturi 405
20' Sno- Gem, 403
20' Dyna mic 401

20' ADCO Roofing Products/Mill ennium Adhesives/E TERNABOND 515

20' SFS intec, Inc. 615

20' Commercial Products Group 717

20' Malarkey Roofing Products 817

20' Hunter Panels 811

20' Leister USA 711

20' Hunter Panels 811

20' Leister USA 711

20' Hunter Panels 811

20' Leister USA 711

20' Hunter Panels 811

20' Leister USA 711

20' EZES TEPC 221
20' Van Mark 320
20' Metal Const 219
20' AMS Controls 217
20' Buildi ng 217

20' AMSI Supply 319
20' Frankl in 317
20' ATAS Information 313
20' Triangle Fastener 412

20' Berger Building 421
20' PPG Indust 419
20' Metal Sales 417
20' World Gutter Systems, Inc. 411
20' Berridge Manufacturi 405
20' Sno- Gem, 403
20' Dyna mic 401

20' Berger Building 421
20' PPG Indust 419
20' Metal Sales 417
20' World Gutter Systems, Inc. 411
20' Berridge Manufacturi 405
20' Sno- Gem, 403
20' Dyna mic 401

20' Berger Building 421
20' PPG Indust 419
20' Metal Sales 417
20' World Gutter Systems, Inc. 411
20' Berridge Manufacturi 405
20' Sno- Gem, 403
20' Dyna mic 401

20' Berger Building 421
20' PPG Indust 419
20' Metal Sales 417
20' World Gutter Systems, Inc. 411
20' Berridge Manufacturi 405
20' Sno- Gem, 403
20' Dyna mic 401

20' Berger Building 421
20' PPG Indust 419
20' Metal Sales 417
20' World Gutter Systems, Inc. 411
20' Berridge Manufacturi 405
20' Sno- Gem, 403
20' Dyna mic 401

20' Berger Building 421
20' PPG Indust 419
20' Metal Sales 417
20' World Gutter Systems, Inc. 411
20' Berridge Manufacturi 405
20' Sno- Gem, 403
20' Dyna mic 401

20' Berger Building 421
20' PPG Indust 419
20' Metal Sales 417
20' World Gutter Systems, Inc. 411
20' Berridge Manufacturi 405
20' Sno- Gem, 403
20' Dyna mic 401

20' Berger Building 421
20' PPG Indust 419
20' Metal Sales 417
20' World Gutter Systems, Inc. 411
20' Berridge Manufacturi 405
20' Sno- Gem, 403
20' Dyna mic 401

20' Berger Building 421
20' PPG Indust 419
20' Metal Sales 417
20' World Gutter Systems, Inc. 411
20' Berridge Manufacturi 405
20' Sno- Gem, 403
20' Dyna mic 401

20' Berger Building 421
20' PPG Indust 419
20' Metal Sales 417
20' World Gutter Systems, Inc. 411
20' Berridge Manufacturi 405
20' Sno- Gem, 403
20' Dyna mic 401

20' Berger Building 421
20' PPG Indust 419
20' Metal Sales 417
20' World Gutter Systems, Inc. 411
20' Berridge Manufacturi 405
20' Sno- Gem, 403
20' Dyna mic 401

20' Berger Building 421
20' PPG Indust 419
20' Metal Sales 417
20' World Gutter Systems, Inc. 411
20' Berridge Manufacturi 405
20' Sno- Gem, 403
20' Dyna mic 401

20' Sealite 213
20' Topps Produ 211
20' McEroy Metal 310

20' ATAS Information 313
20' Triangle Fastener 412

20' Berger Building 421
20' PPG Indust 419
20' Metal Sales 417
20' World Gutter Systems, Inc. 411
20' Berridge Manufacturi 405
20' Sno- Gem, 403
20' Dyna mic 401

20' Berger Building 421
20' PPG Indust 419
20' Metal Sales 417
20' World Gutter Systems, Inc. 411
20' Berridge Manufacturi 405
20' Sno- Gem, 403
20' Dyna mic 401

20' Berger Building 421
20' PPG Indust 419
20' Metal Sales 417
20' World Gutter Systems, Inc. 411
20' Berridge Manufacturi 405
20' Sno- Gem, 403
20' Dyna mic 401

20' Berger Building 421
20' PPG Indust 419
20' Metal Sales 417
20' World Gutter Systems, Inc. 411
20' Berridge Manufacturi 405
20' Sno- Gem, 403
20' Dyna mic 401

20' Berger Building 421
20' PPG Indust 419
20' Metal Sales 417
20' World Gutter Systems, Inc. 411
20' Berridge Manufacturi 405
20' Sno- Gem, 403
20' Dyna mic 401

20' Berger Building 421
20' PPG Indust 419
20' Metal Sales 417
20' World Gutter Systems, Inc. 411
20' Berridge Manufacturi 405
20' Sno- Gem, 403
20' Dyna mic 401

20' Berger Building 421
20' PPG Indust 419
20' Metal Sales 417
20' World Gutter Systems, Inc. 411
20' Berridge Manufacturi 405
20' Sno- Gem, 403
20' Dyna mic 401

20' Berger Building 421
20' PPG Indust 419
20' Metal Sales 417
20' World Gutter Systems, Inc. 411
20' Berridge Manufacturi 405
20' Sno- Gem, 403
20' Dyna mic 401

20' Berger Building 421
20' PPG Indust 419
20' Metal Sales 417
20' World Gutter Systems, Inc. 411
20' Berridge Manufacturi 405
20' Sno- Gem, 403
20' Dyna mic 401

20' Berger Building 421
20' PPG Indust 419
20' Metal Sales 417
20' World Gutter Systems, Inc. 411
20' Berridge Manufacturi 405
20' Sno- Gem, 403
20' Dyna mic 401

20' Berger Building 421
20' PPG Indust 419
20' Metal Sales 417
20' World Gutter Systems, Inc. 411
20' Berridge Manufacturi 405
20' Sno- Gem, 403
20' Dyna mic 401

20' Berger Building 421
20' PPG Indust 419
20' Metal Sales 417
20' World Gutter Systems, Inc. 411
20' Berridge Manufacturi 405
20' Sno- Gem, 403
20' Dyna mic 401

20' All Steel 207
20' A.C.T. Metal 205
20' Metal Roofi 203
20' Direct Metal 201

20' TennSmith, Inc. 301

20' Berger Building 421
20' PPG Indust 419
20' Metal Sales 417
20' World Gutter Systems, Inc. 411
20' Berridge Manufacturi 405
20' Sno- Gem, 403
20' Dyna mic 401

20' Berger Building 421
20' PPG Indust 419
20' Metal Sales 417
20' World Gutter Systems, Inc. 411
20' Berridge Manufacturi 405
20' Sno- Gem, 403
20' Dyna mic 401

20' Berger Building 421
20' PPG Indust 419
20' Metal Sales 417
20' World Gutter Systems, Inc. 411
20' Berridge Manufacturi 405
20' Sno- Gem, 403
20' Dyna mic 401

20' Berger Building 421
20' PPG Indust 419
20' Metal Sales 417
20' World Gutter Systems, Inc. 411
20' Berridge Manufacturi 405
20' Sno- Gem, 403
20' Dyna mic 401

20' Berger Building 421
20' PPG Indust 419
20' Metal Sales 417
20' World Gutter Systems, Inc. 411
20' Berridge Manufacturi 405
20' Sno- Gem, 403
20' Dyna mic 401

20' Berger Building 421
20' PPG Indust 419
20' Metal Sales 417
20' World Gutter Systems, Inc. 411
20' Berridge Manufacturi 405
20' Sno- Gem, 403
20' Dyna mic 401

20' Berger Building 421
20' PPG Indust 419
20' Metal Sales 417
20' World Gutter Systems, Inc. 411
20' Berridge Manufacturi 405
20' Sno- Gem, 403
20' Dyna mic 401

20' Berger Building 421
20' PPG Indust 419
20' Metal Sales 417
20' World Gutter Systems, Inc. 411
20' Berridge Manufacturi 405
20' Sno- Gem, 403
20' Dyna mic 401

20' Berger Building 421
20' PPG Indust 419
20' Metal Sales 417
20' World Gutter Systems, Inc. 411
20' Berridge Manufacturi 405
20' Sno- Gem, 403
20' Dyna mic 401

20' Berger Building 421
20' PPG Indust 419
20' Metal Sales 417
20' World Gutter Systems, Inc. 411
20' Berridge Manufacturi 405
20' Sno- Gem, 403
20' Dyna mic 401

20' Berger Building 421
20' PPG Indust 419
20' Metal Sales 417
20' World Gutter Systems, Inc. 411
20' Berridge Manufacturi 405
20' Sno- Gem, 403
20' Dyna mic 401

20' Berger Building 421
20' PPG Indust 419
20' Metal Sales 417
20' World Gutter Systems, Inc. 411
20' Berridge Manufacturi 405
20' Sno- Gem, 403
20' Dyna mic